

## MAINTENANCE

Scheduled Maintenance	Normal Usage		Severe Usage*	
Engine Oil and Filter (2.4 GDI)	Replace	7,500 or 12 mos.	Replace	3,750 or 6 mos.
Engine Oil and Filter (2.0 TGDl)	1st Replace 3,000 or 6 mos. Add'l Replace 4,800 or 6 mos.		Replace	3,000 or 3 mos.
Fuel Additive (2.4 GDI) *1	Add	7,500 or 12 mos.	Add	Same as Normal
Fuel Additive (2.0 TGDl) *1	1st Add 3,000 or 6 mos. Add'l Add 4,800 or 6 mos.		Add	Same As Normal
Tire Rotation	Perform	7,500	Perform	7,500
Air Cleaner Filter	Inspect Replace	7,500 30,000	Inspect Replace	Same As Normal More Frequently
Vacuum Hose	Inspect	7,500	Inspect	Same As Normal
Climate Control Air Filter (for Evaporator and Blower Unit)	Replace	15,000	Replace	More Frequently
Air Conditioning Refrigerant	Inspect	15,000	Inspect	Same As Normal
Brake Hoses & Lines	Inspect	15,000	Inspect	Same As Normal
Drive Shafts & Boots	Inspect	15,000	Inspect	7,500
Exhaust Pipe & Muffler	Inspect	15,000	Inspect	Same As Normal
Front Disc Brake/Pads, Calipers & Rotors	Inspect	15,000	Inspect	More Frequently
Steering Gear Box, Linkage & Boots/ Lower Arm Ball Joint, Upper Arm Ball Joint	Inspect	15,000	Inspect	More Frequently
Suspension Mounting Bolts	Inspect	15,000	Inspect	Same As Normal
Brake/Clutch Fluid	Inspect	30,000	Inspect	Same As Normal
Crankcase Ventilation Hose	Inspect	30,000	Inspect	Same As Normal
Fuel Filter	Inspect	30,000	Inspect	Same As Normal
Fuel Lines, Fuel Hoses and Connections	Inspect	30,000	Inspect	Same As Normal
Fuel Tank Air Filter	Inspect	30,000	Inspect	Same As Normal
Rear Disc Brake/Pads, Parking Brake	Inspect	30,000	Replace	More Frequently
Vapor Hose, Fuel Tank & Fuel Filler Cap	Inspect	30,000	Replace	Same As Normal
Manual Transaxle Fluid	Inspect	37,500	Replace	7,500
Valve Clearance	Inspect	60,000	Inspect	Same As Normal
Spark Plugs (2.4 Engine)	Replace	105,000	Replace	More Frequently
Spark Plugs (2.0 Engine)	Replace	45,000	Replace	More Frequently
Drive Belt (Alt, A/C)	1st Inspect 60,000 or 72 mos. Add'l Inspect 15,000 or 24 mos.		Inspect	Same As Normal
Coolant	1st Replace 60,000 or 60 mos. Add'l Replace 30,000 or 24 mos.		Replace	Same As Normal
Automatic Transmission Fluid	No check, No service required		Replace	60,000
*1 If TOP TIER Detergent Gasoline is not available, one bottle of additive is recommended. Additives are available from your authorized Hyundai dealer along with information on how to use them. Do not mix other additives.				
*See Owner's Manual for details.				

**Looking for more detailed information?** This Quick Reference Guide does not replace your vehicle's Owner's Manual. If you require additional information or are unsure of a specific issue, you should always refer to the vehicle's Owner's Manual or contact your authorized Hyundai dealer.

The information contained in this Quick Reference Guide was correct at the time of printing; however, specifications and equipment can change without notice. No warranty or guarantee is being extended in this Quick Reference Guide, and Hyundai reserves the right to change product specifications and equipment at any time without incurring obligations. Some vehicles are shown with optional equipment. Specifications apply to U.S. vehicles only. Please contact your Hyundai dealer for current vehicle specifications. Please contact your Hyundai dealer for current vehicle specifications.

NP150-F2014  
(REV 08/26/13)  
Printing 08/26/13

HYUNDAI

**SONATA**

Quick Reference Guide



[www.hyundai.com](http://www.hyundai.com)

 **HYUNDAI**  
NEW THINKING.  
NEW POSSIBILITIES.

Roadside Assistance: **1-800-243-7766**

Consumer Affairs: **1-800-633-5151**

XM® Radio: **1-800-967-2346**

Blue Link: **1-855-2BLUELINK  
(1-855-225-8354)**

# Table of contents

## GETTING STARTED

Central door lock switch	07
Cruise control system	20
Engine start/stop button	03
Front seat adjustment	04
Headrest adjustment	05
Rear seat folding	05
Remote keyless entry	02
Seat belt adjustment	05
Trunk Opening	03

## FEATURES AND CONTROLS

Active ECO system	35
AUX, USB, and iPod® ports	32
Climate control - Manual	16-17
Climate control - Automatic	18-19
Clock adjustment	32
Driver's main controls	07
Driver selectable steering mode	21
Electronic Stability Control (ESC)	34
Fuel door	06
Head lights and fog lights	08
HomeLink wireless control system	11
Instrument cluster	12-15
Instrument panel illumination	13-15
Interior lights	10-11
Paddle shifter	33
Rearview camera	35
Seat Warmer/Cooler	37
Steering wheel adjustment	06
Sunroof	10
Tire Pressure Monitoring System (TPMS)	34
Transmission	33
Trip computer	13-15
Wiper and washer	09

## MULTIMEDIA

Blue Link telematic system	26
Bluetooth® phone operation	24
Bluetooth® phone operational tips	22-23
Bluetooth® phone pairing	24
Navigation	30-31
Standard radio	28-29

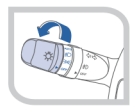

Head lights and fog lights  
Page08



Instrument cluster  
Page12-15



Trip computer  
Page13-15



Cruise control system  
Page20



Wiper and washer  
Page09



Audio  
Page28-29

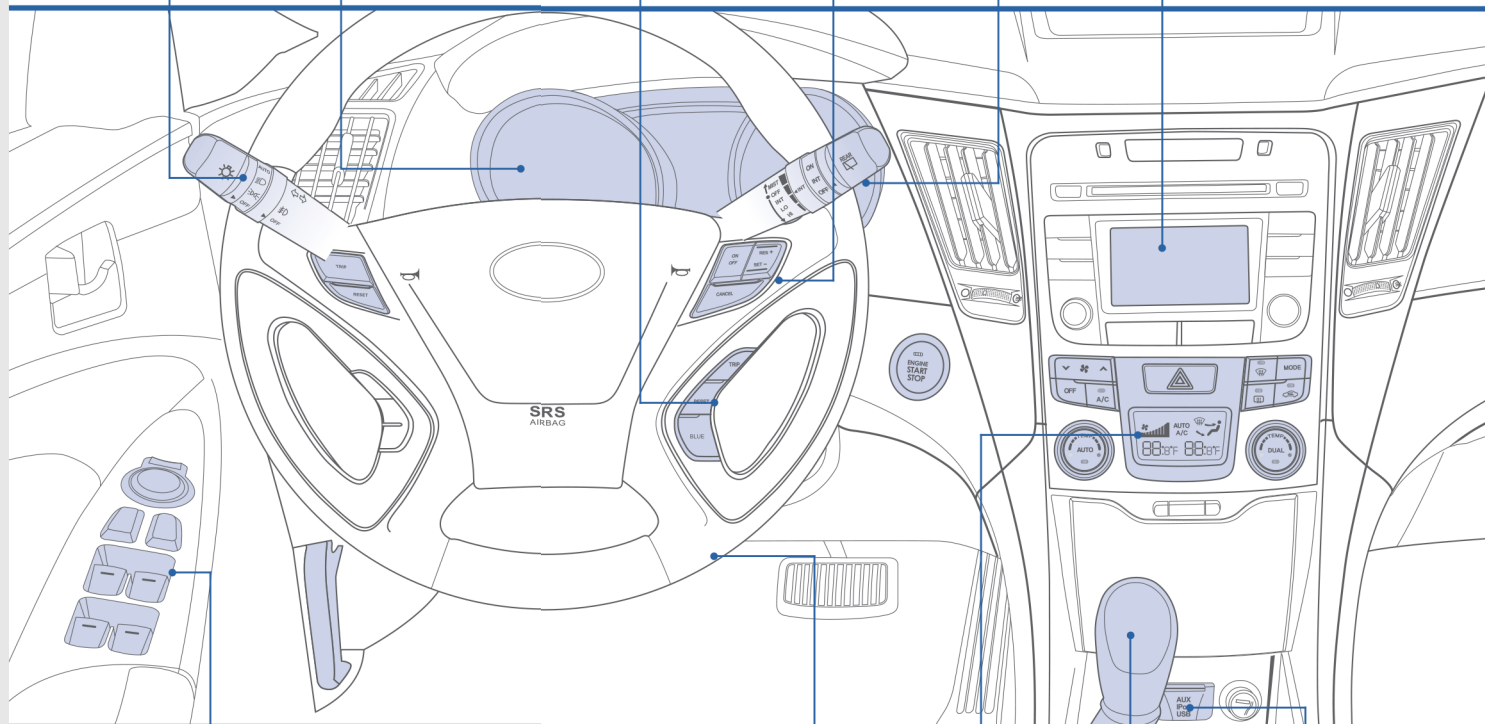

Power window  
Page07

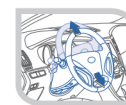

Tilt and telescopic Steering wheel  
Page06



Automatic climate control  
Page18-19



Automatic transmission  
Page33







AUX, USB and iPod® port  
Page32

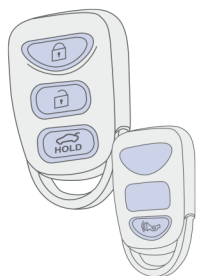

## REMOTE KEYLESS ENTRY



-  Lock
-  Unlock
-  Trunk unlock
-  Panic

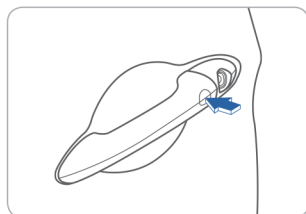

### Driver's door Lock / Unlock

Smart key must be within range.

#### Press:

- Once – Unlock driver door
- Twice – Unlock all doors
- Third – Lock all doors



### Remove mechanical key

Press and hold the release **A** button and remove the key.

### Reinstall mechanical key

Put the key into the hole and push it until a click sound is heard.



## TRUNK OPENING

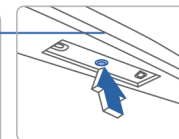
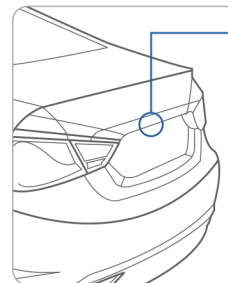

Press to open.  
Smart key needs to be within range.

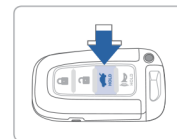

Press and hold to open.

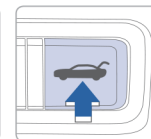

Press the release button located on the left side of the dashboard.

## ENGINE START/STOP BUTTON

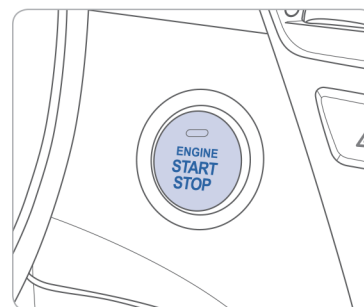

With the ignition OFF, press the engine start/stop button:

- Once for ACC (Accessory) mode.
- Twice for ON mode.
- Three times for OFF.

To start the engine, press the start/stop button while depressing the brake pedal. To shut engine OFF, shift to P (Park) and press the start/stop button.

### Emergency situations

#### Shut off engine while driving:

- Press engine start/stop button for more than 2 seconds or press it 3 times consecutively within 3 seconds.

#### Restart engine while driving

- Press engine start/stop button with shift lever in N (Neutral).

## FRONT SEAT ADJUSTMENT (Manual)

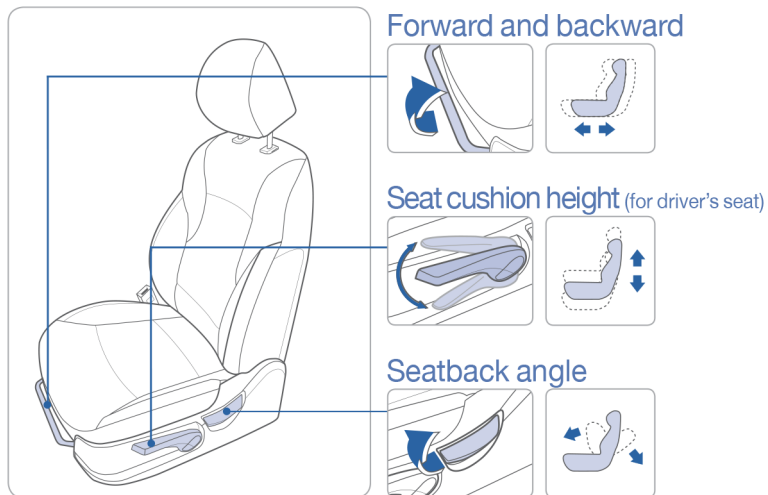

## FRONT SEAT ADJUSTMENT (Power)

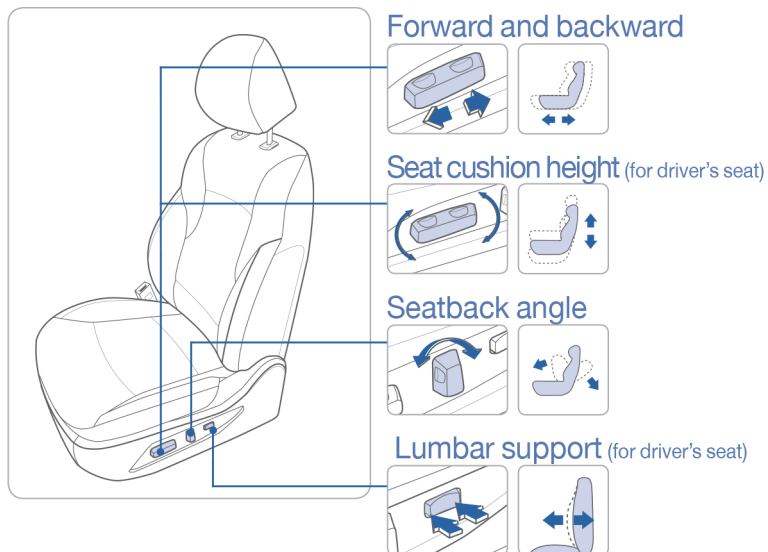

## REAR SEAT FOLDING

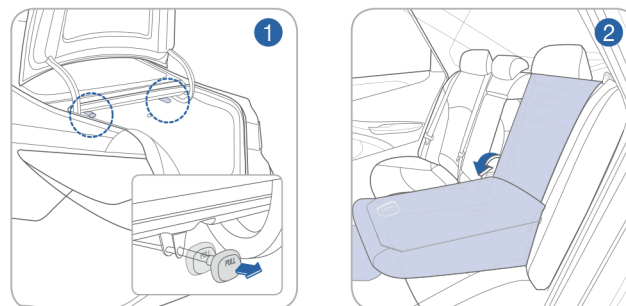

## HEADREST ADJUSTMENT

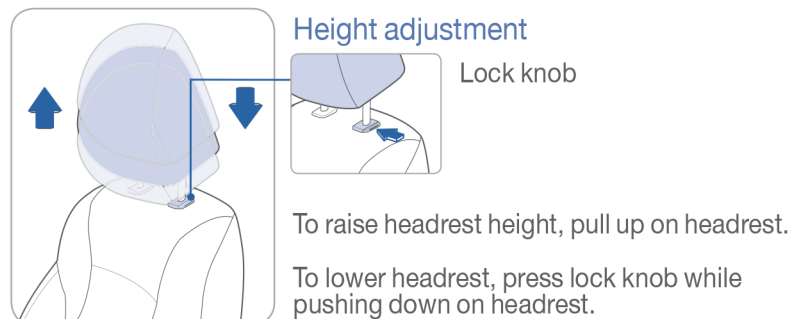

## SEAT BELT ADJUSTMENT (Front seat)

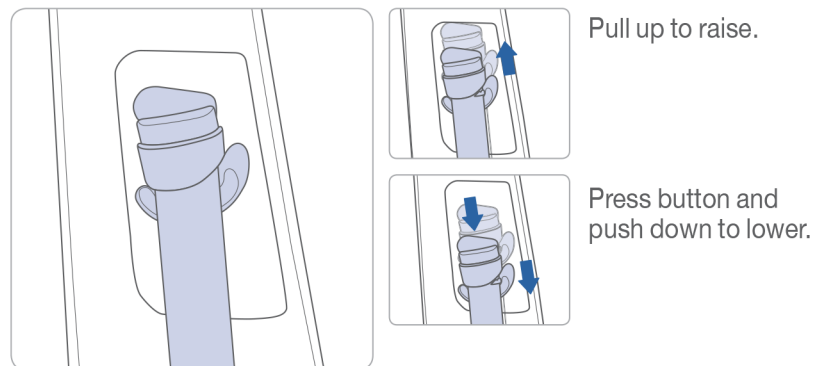



## STEERING WHEEL ADJUSTMENT

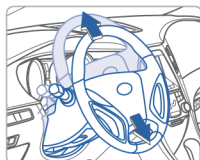
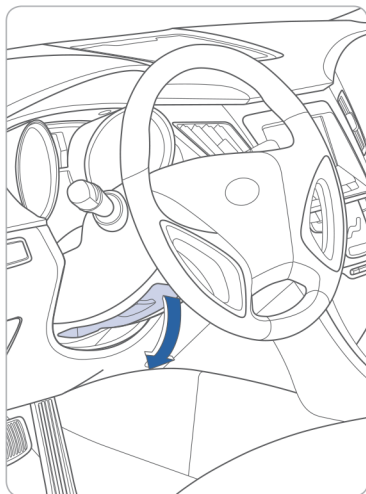

Tilt

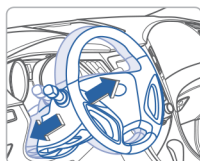

Telescopic

- CAUTION:** Do not adjust while driving.
1. Push the lever downward to release.
  2. Set the angle and height.
  3. Pull the lever upward to lock in place.

## DRIVER'S MAIN CONTROLS

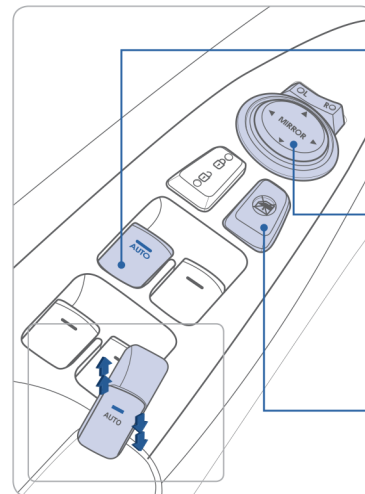

Window Auto down/up (driver's side only)

Press past detent to fully open/close window.

Outside Rearview Mirrors

Press L (left) or R (right) on the switch. Then adjust the mirror by using the directional switch.

Power Window Lock Switch

Disables the power window switches on the passenger doors.

## FUEL DOOR

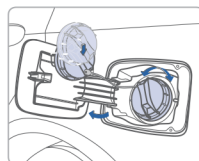
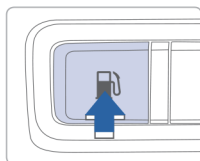
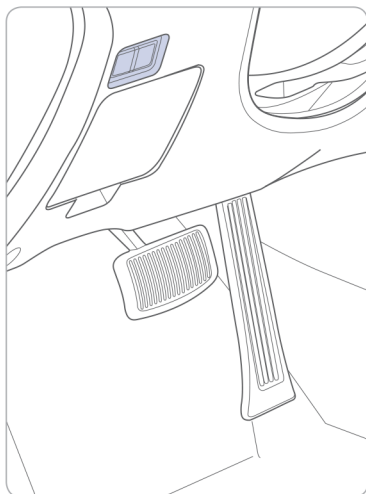

### NOTE

After adding fuel, always reinstall the fuel cap onto the filler neck by rotating it clockwise until it clicks one time.

Failure to do this may result in the Check Engine Light (🔧) illuminating.

## CENTRAL DOOR LOCK SWITCH

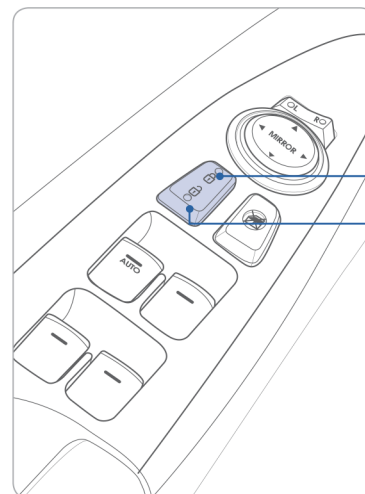

All doors will lock

All doors will unlock

## HEADLIGHTS AND FOG LIGHTS

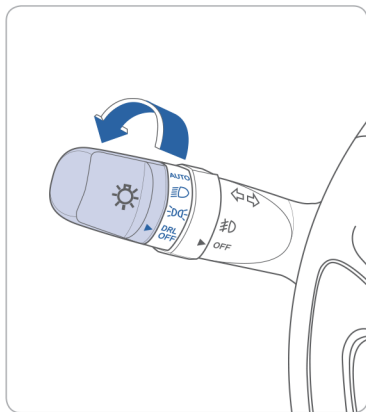

- ▶ | **AUTO** Auto light (if equipped)
- ▶ | Head light
- ▶ | Parking light
- ▶ | **DRLOFF** OFF

### Escort Function

Head lights may stay on for 15 seconds after exiting and locking vehicle. Press remote lock button twice to turn head lights off.

### Turn signals and lane change signals

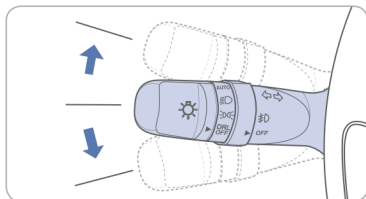

### Flashing head lights

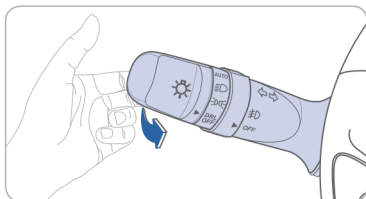

### High beam

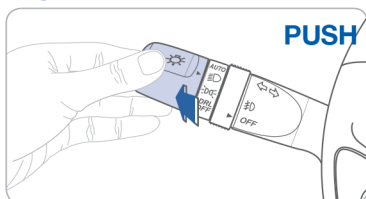

### Fog light

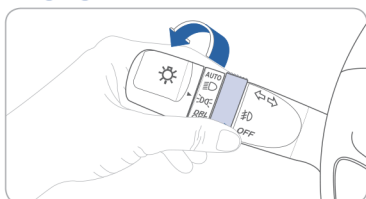

## WIPER AND WASHER

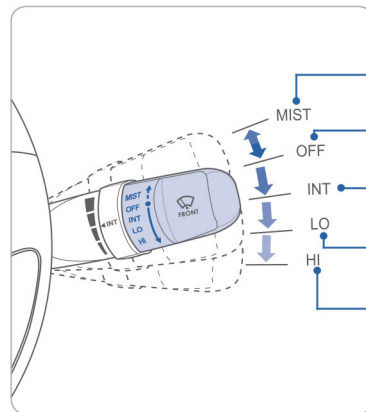

- MIST** - Single wipe
- OFF** - Off
- INT** - Intermittent wipe
- LO** - Normal wiper speed
- HI** - Fast wiper speed

### Intermittent wipe time adjustment

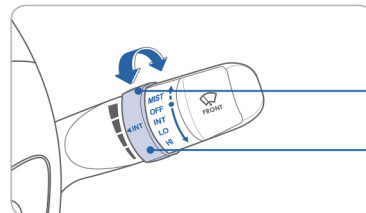

Fast wiper speed

Slow wiper speed

### Wash with brief wipes

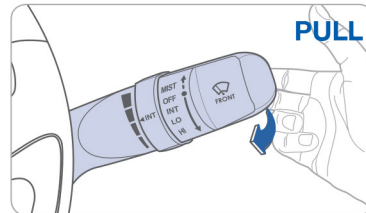

## SUNROOF

### Sliding the sunroof

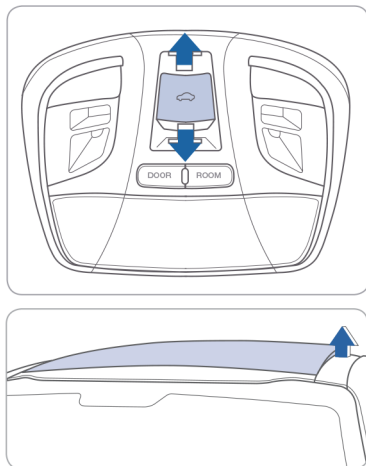

#### Open

- Press switch rearward.
- Press switch rearward past the detent to open completely.

#### Close

- Press switch forward.
- Press switch forward past the detent to close completely.

#### Tilt

Push or pull switch up or down.

## INTERIOR LIGHTS

### Type A

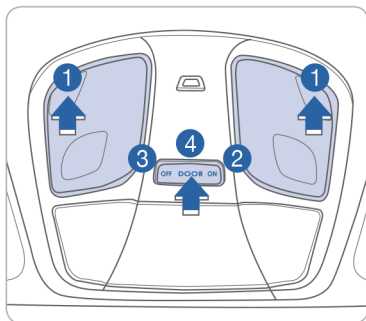

Push the lens ① to turn the map lamp on or off.

#### ON ②

Light will turn on.

#### OFF ③

The lights stay off at all times except when individually turned on.

The lights automatically turn off approximately 20 minutes after the ignition switch is turned off or 5 seconds after the system is armed.

#### DOOR ④

Map lamp and room lamp comes on when a door is opened.

### Type B

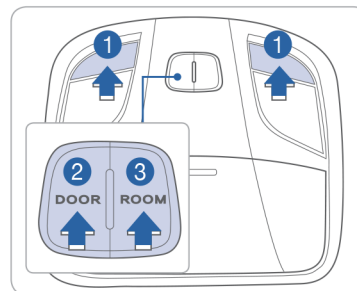

Push the lens ① to turn the map lamp on or off. The lights automatically turn off approximately 20 minutes after the ignition switch is turned off or 5 seconds after the system is armed.

#### DOOR ②

Map lamp and room lamp comes on when doors are unlocked with a transmitter or smart key.

#### ROOM ③

Map lamp and room lamp comes on.

### Sunroof

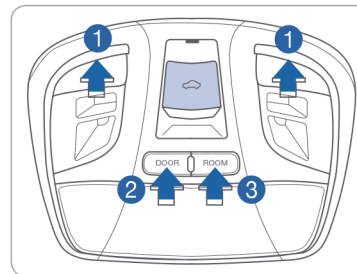

Push the lens ① to turn the map lamp on or off.

#### DOOR ②

Map lamp and room lamp comes on when doors are unlocked with a transmitter or smart key.

#### ROOM ③

Map lamp and room lamp comes on.

## HOMELINK WIRELESS CONTROL SYSTEM

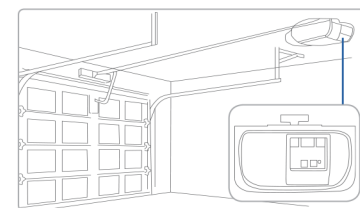
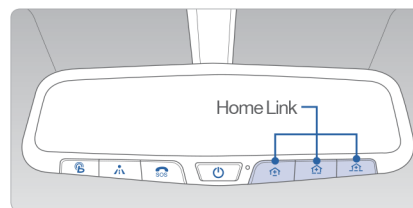

### Programming Rolling Code Garage

Press and hold your selected HomeLink button for 20 seconds.

Release when light flashes rapidly.

Press and release the "learn" or "smart" button on the garage door opener motor-head unit.

(Note: 30 second window to initiate next step.)

Press and hold the desired HomeLink button for 2 seconds and release.

Repeat this sequence up to 3 times. If programming is successful, the garage door should open or close during this step.

For detailed instructions including "Standard type" garage door, refer to your Owner's Manual or visit [www.homelink.com](http://www.homelink.com).

## FEATURES AND CONTROLS

### Type A

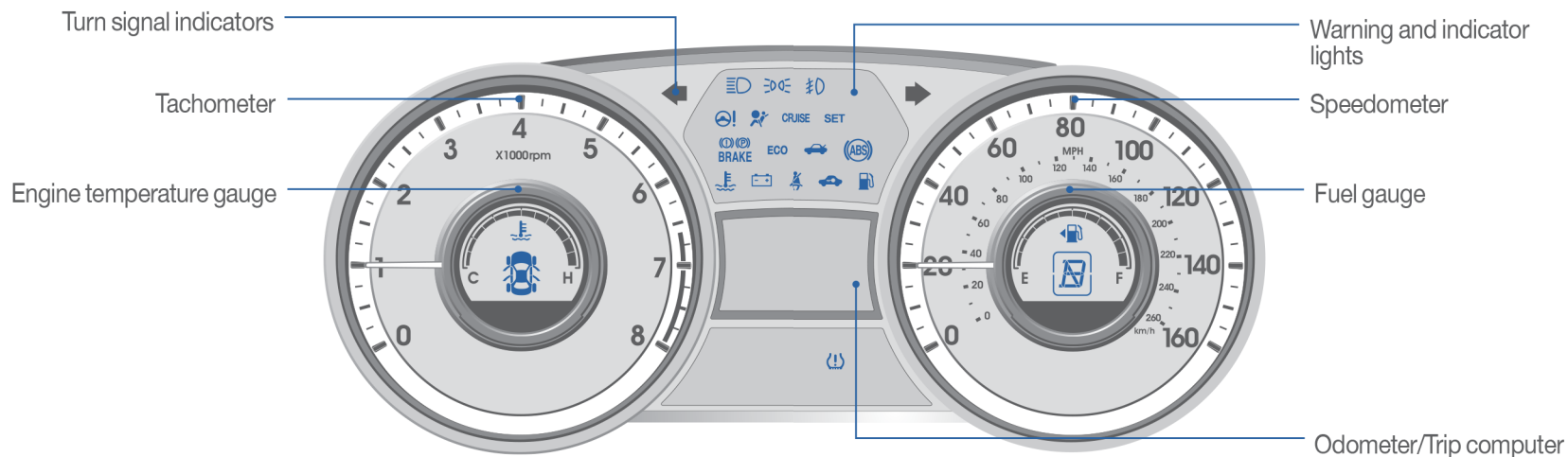

### WARNINGS AND INDICATORS

Air bag warning light	Parking brake & Brake fluid warning light	ABS warning light
Seat belt warning light	Low Tire Pressure / TPMS (Tire Pressure Monitoring System) malfunction indicator	
High beam indicator	Engine oil pressure warning light	Charging system warning light
Electronic Power Steering system warning light	Door open position indicator	Turn signal indicator
Immobilizer indicator	Automatic transmission shift indicator	Manual transmission shift indicator
Trunk open warning light	Low fuel level warning light	ESC(Electronic Stability Control) indicator
ESC(Electronic Stability Control) OFF indicator	Cruise indicator	Malfunction indicator light
Cruise SET indicator	Front fog light indicator	ECO indicator
Light on indicator		

### INSTRUMENT PANEL ILLUMINATION

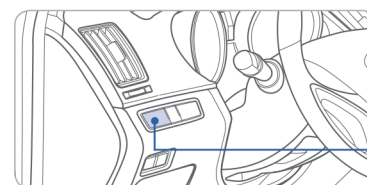

Push the control switch left or right to adjust the brightness.

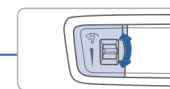

### TRIP COMPUTER

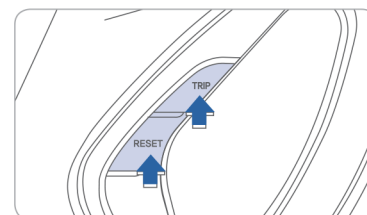

Press the TRIP button for less than 1 second to select function as follows:

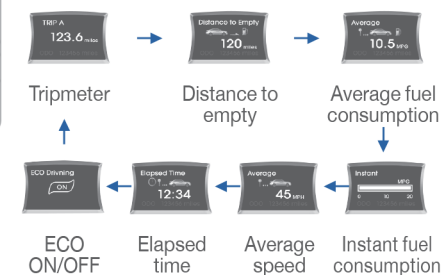

To reset Tripmeter, press and hold RESET button.



## FEATURES AND CONTROLS

### Type B

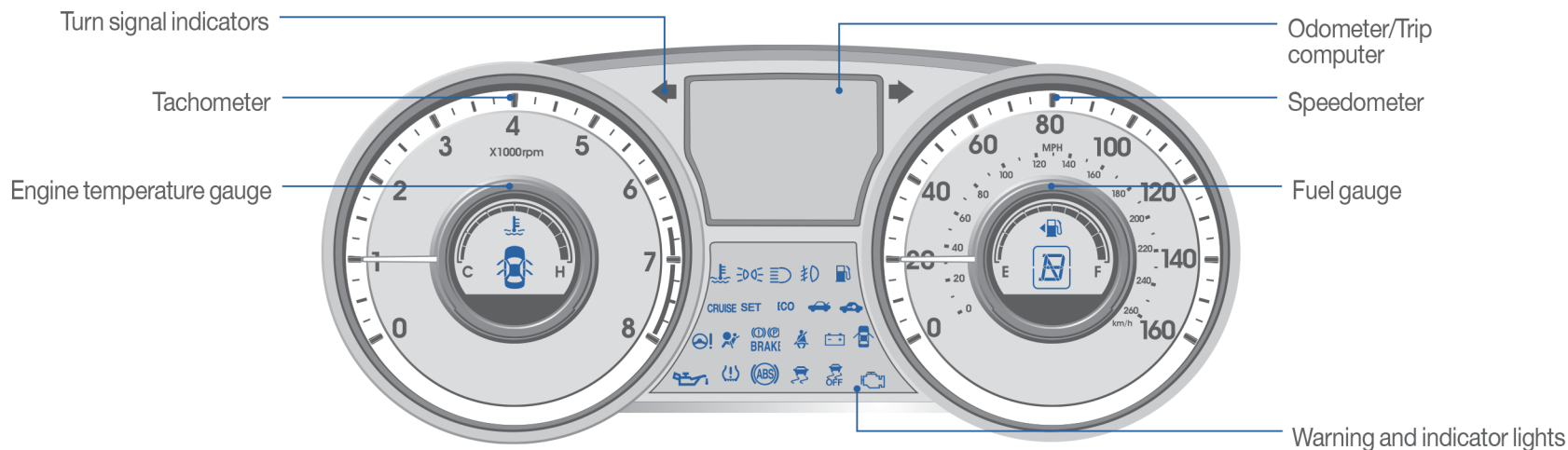

### WARNINGS AND INDICATORS

Air bag warning light	Parking brake & Brake fluid warning light	ABS warning light
Seat belt warning light	Low Tire Pressure / TPMS (Tire Pressure Monitoring System) malfunction indicator	
High beam indicator	Engine oil pressure warning light	Charging system warning light
Electronic Power Steering system warning light	Door open position indicator	Turn signal indicator
Immobilizer indicator	Automatic transmission shift indicator	Manual transmission shift indicator
Trunk open warning light	Low fuel level warning light	ESC(Electronic Stability Control) indicator
ESC(Electronic Stability Control) OFF indicator	Cruise indicator	Malfunction indicator light
Cruise SET indicator	Front fog light indicator	ECO indicator
Light on indicator		

### INSTRUMENT PANEL ILLUMINATION

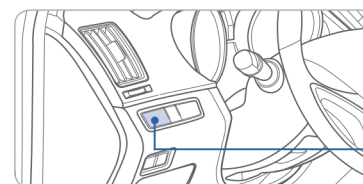

Push the control switch left or right to adjust the brightness.



### TRIP COMPUTER

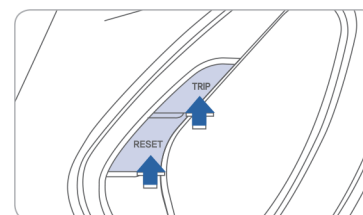

Press the TRIP button for less than 1 second to select function as follows:

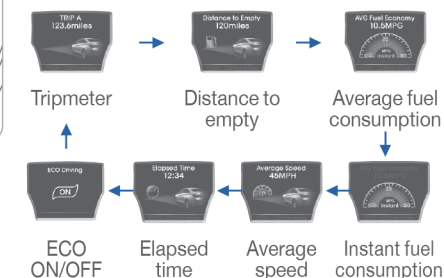

To reset Tripmeter, press and hold RESET button.

## FEATURES AND CONTROLS

### MANUAL CLIMATE CONTROL SYSTEM

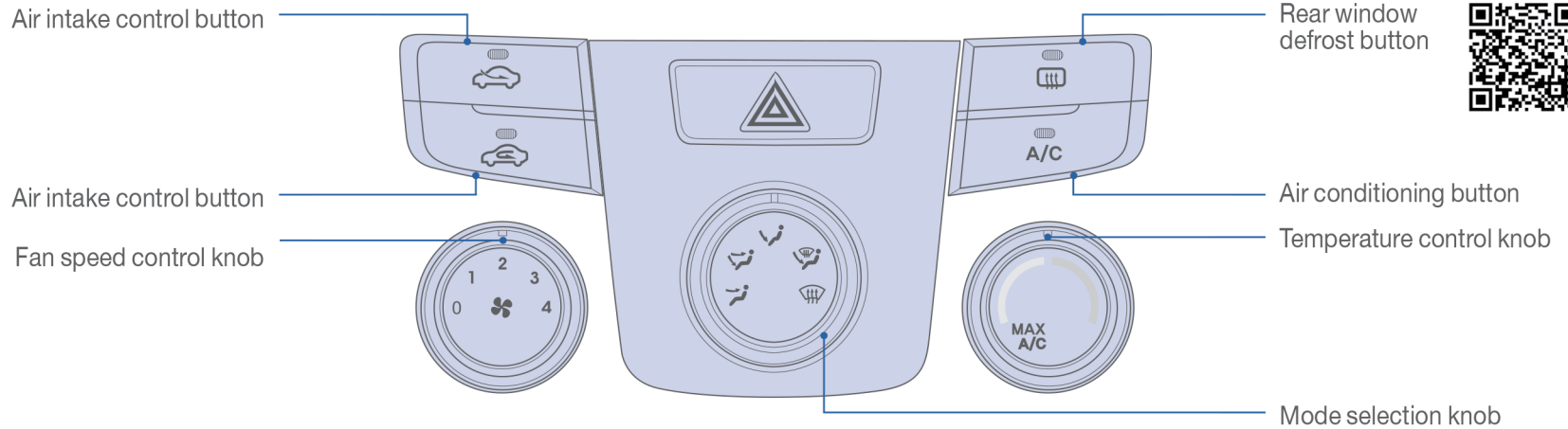

#### DEFROSTING / DEFOGGING



1. Press the front windshield defrost control button.



2. Set the temperature control to the warmest setting.



3. Set the fan speed to the highest setting.

#### AIR INTAKE CONTROL

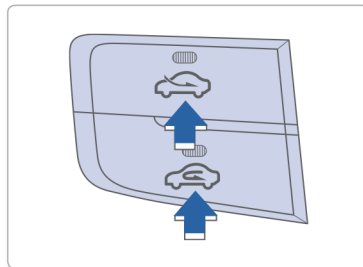

Recirculated air position



Outside(fresh) air position

#### MODE SELECTION

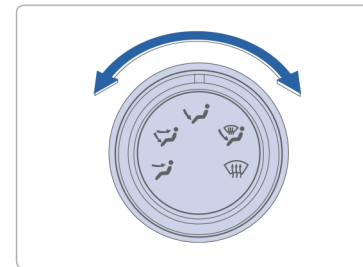

Changing the direction of the air flow as follows:



Face Level



Bi-Level



Floor Level



Floor/Defrost Level



Defrost Level

#### REAR WINDOW DEFROSTER

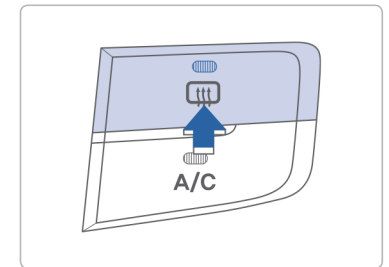

Press to activate/deactivate the rear defroster.



## FEATURES AND CONTROLS

### AUTOMATIC CLIMATE CONTROL SYSTEM [Type A]

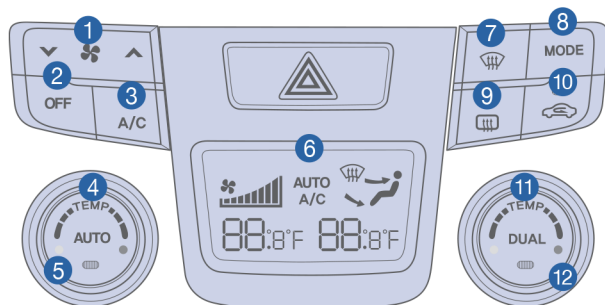

- 1 Fan speed control button
- 2 OFF button
- 3 Air conditioning button
- 4 Driver's temperature control knob
- 5 AUTO (automatic control) button
- 6 A/C display
- 7 Front windshield defrost button
- 8 Mode selection button
- 9 Rear window defrost button
- 10 Air intake control button
- 11 Passenger's temperature control knob
- 12 Dual temperature control selection button

### DEFROSTING / DEFOGGING



1. Press the front windshield defrost control button.



2. Set the temperature control to the warmest setting.



3. Set the fan speed to the highest setting.

### SYSTEM OFF MODE

Pressing the OFF button will place the system in the OFF mode.

- Front blower will turn off.
- Outside (fresh) air position will be selected.
- Vented air will be at last set temperature.

### REAR WINDOW DEFROSTER

#### Type A

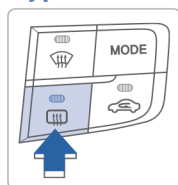

#### Type B

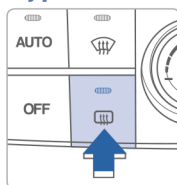

Press to activate/deactivate the rear defroster

### AUTOMATIC CLIMATE CONTROL SYSTEM [Type B]

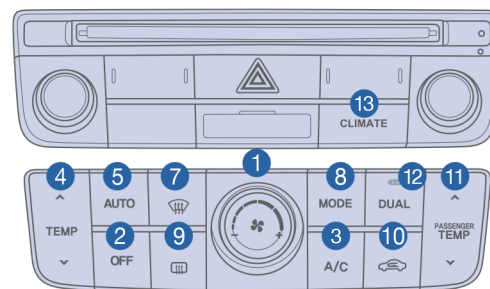

- 9 Rear window defrost button
- 10 Air intake control button
- 11 Passenger's temperature control knob
- 12 Dual temperature control selection button
- 13 Climate information screen selection button

### MODE SELECTION

#### Type A

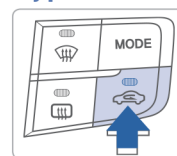

#### Type B

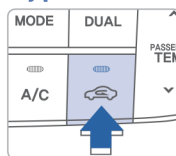

Recirculated air position



Outside(fresh) air position

### DUAL BUTTON

#### Type A

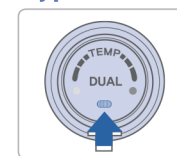

#### Type B

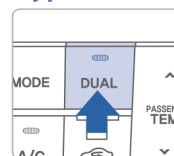

Press the DUAL button to operate the driver's and passenger's side temperature individually.

### MODE SELECTION

#### Type A

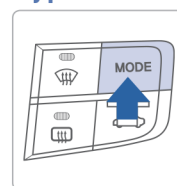

#### Type B

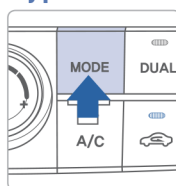

Changing the direction of the air flow as follows:



Face Level

Bi-Level

Floor Level

Floor & Defrost

## CRUISE CONTROL SYSTEM

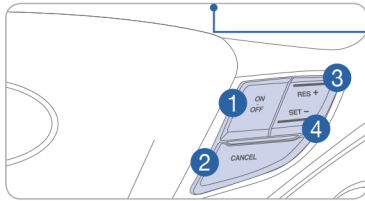

**CRUISE** Cruise indicator

**SET** Cruise set indicator



### To Set a Cruising Speed

1. Press ON/OFF button ① and the CRUISE indicator will illuminate in the instrument cluster.  
Accelerate to desired cruising speed (above 25 mph)
2. Press SET- button ④ and remove your foot from the accelerator pedal and the SET indicator will illuminate

### To Accelerate or Decelerate

Press RES + button ③ up to increase set cruising speed.  
Press SET - button ④ down to decrease set cruising speed.

### To Cancel Cruising Speed

Press CANCEL button ②, depress brake pedal, or press ON/OFF button ①.

## DRIVER SELECTABLE STEERING MODE

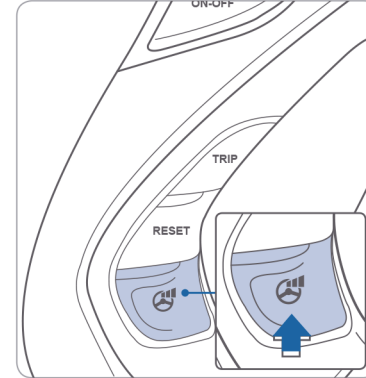

The driver selectable steering mode changes steering effort per driver's preference or road condition.

Pushing the button once tells you what the current mode is on the center of the instrument cluster screen. Pressing the button again will scroll through the different modes.

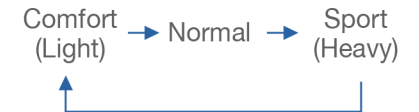



## BLUETOOTH OPERATIONAL TIPS

In the following situations you or the other party may have difficulty hearing each other:

1. Keep the Bluetooth volume to a low level. High level volume may result in distortion and echo.
2. When driving on a rough road, high speeds and/or with the window open.
3. When the air conditioning vents are facing the microphone and/or when the air conditioning fan is at the max speed.

### Steering wheel bluetooth control

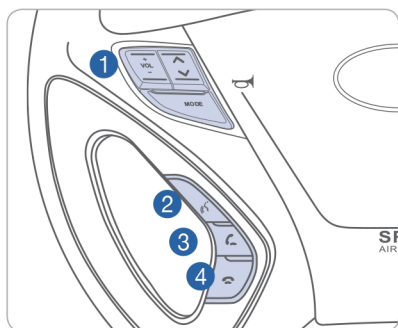

- 1 VOLUME**  
Raises or lowers speaker volume.
- 2 TALK**  
Activates voice recognition.
- 3 CALL**  
Places and transfers calls.
- 4 END**  
Ends calls or cancels functions.

To redial previously dialed number, press and hold **3**.

#### To Answer a Call:

- Press **CALL** button on the steering wheel.

#### To Reject a Call:

- Press **END** button on the steering wheel.

#### To Adjust Ring Volume:

- Use the VOLUME buttons on the steering wheel.

#### To Transfer a Call to the Phone

##### (Secret Call):

- Press and hold **CALL** button on the steering wheel until the audio system transfers a call to the phone.

#### To Finish a Call:

- Press **END** button on the steering wheel.

### Making a call using voice recognition:

The menu tree identifies available voice recognition Bluetooth® functions.

#### Calling by Name:

1. Press button.
2. Say the following command:
  - “Call <John>”: Connects the call to John.
  - “Call <John> on <Mobile/Home/Office>”: Connects the call to John’s Mobile, Home, or Office phone number.

#### Dialing by Number:

1. Press button.
2. Say “Call”.
3. Say “By number” when prompted.
4. Say desired phone numbers.
5. Say “Dial” to complete the number and make a call.

For complete list of commands, refer to your Owner’s Manual.

## VOICE RECOGNITION TIPS

Your vehicle is equipped with Voice Recognition technology which allows drivers to operate their phones without having to take their eyes off the road to minimize distractions.

Voice recognition performance may be affected if driving with windows and sun roof open; when the heating-cooling system is on; when passing in a tunnel or when driving on rugged and uneven roads.

Quick reference on using voice commands

To start voice command. Press the key, the following commands are available:

Command	Function
More Help	Provides guidance on commands that can be used anywhere in the system
Help	Provides guidance on commands that can be used within the current mode.
Calls <Name>	Calls <Name> saved in Contacts. Ex) Call “John”
Dial <Number>	Call can be made by dialing the spoken numbers. Ex) Call “123”
Phone	Provides guidance on Phone related commands. After saying this command, say “Call History”, “Contacts” to execute corresponding functions.
Call History	Displays the Call History screen.
Contacts (Call by Name)	Displays the Contacts screen. After saying this command, say the name of a contact saved in the Contacts to automatically connect the cell.
Dial Number	Display the Dial number screen. After saying this command, you can say the number what you want to call.



## MULTIMEDIA

### BLUETOOTH PHONE PAIRING

Pairing tutorials, phone compatibility and Operational tips can be found through the Smart QR code using the QR reader application on your Smartphone.



### BLUETOOTH PHONE OPERATION

Vehicle must be in Park to complete phone pairing process.

#### Standard Radio

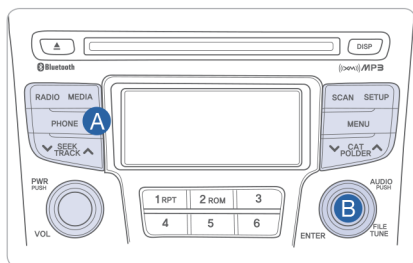

1. Press the PHONE button **A**.
2. Rotate the TUNE knob **B**, to "PAIR PHONE", then push knob to select.
3. Enable Bluetooth® from your mobile phone.
4. Select "SONATA" from the device list from your mobile phone. Input passkey displayed on screen.

5. After pairing is completed, transfer of the contact list to the audio system will begin (if your phone is supported).

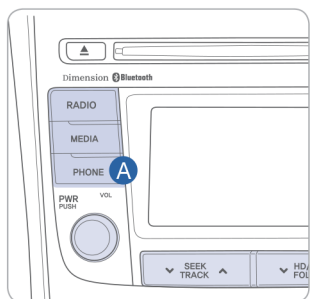

1. Press the PHONE button **A**.
2. Press the PAIR button on the screen.
3. Enable Bluetooth® from your mobile phone. Press OK button from the screen.
4. Select "SONATA" from the device list from your mobile phone. Input passkey displayed on screen.
5. After pairing is completed, transfer of the contact list to the audio system will begin (if your phone is supported).

Please visit [www.hyundaiusa.com/bluetooth](http://www.hyundaiusa.com/bluetooth) for a list of compatible phones tested to work with Hyundai's Bluetooth® system.



### Navigation Radio

NOTE: Vehicle must be in park to complete the pairing process.

1. Press the call button **A** on the steering wheel or press the PHONE button **B** on the radio.

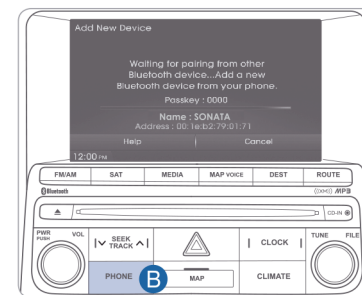
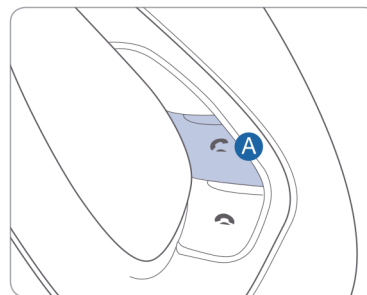

2. Press "Yes" button on the screen.
3. Enable Bluetooth® on your phone. Select "SONATA" from the device list on your mobile phone and input the passkey displayed on the screen.
4. After pairing is completed, transfer of the contact list to the audio system will begin (if your phone is supported).

Please visit [www.hyundaiusa.com/bluetooth](http://www.hyundaiusa.com/bluetooth) for a list of compatible phones tested to work with Hyundai's Bluetooth® system.



## MULTIMEDIA



### BLUE LINK TELEMATIC SYSTEM

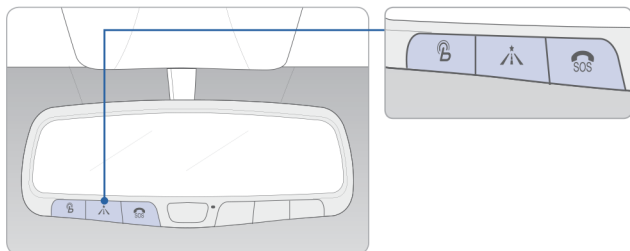

Press the **B** button for access to the voice-response menu of services. You have two options:

- You can say, "Main Menu" for a listing of main menu choices.
- You can directly select any of the listed menu items by saying its name.

			
Navigation	Information	Essentials	Vehicle Assist
New Destination Gas Prices Restaurant Ratings Route Assistance Daily Route Guide Main Menu	Traffic Weather Valet Alert Main Menu	Voice Texting Location Sharing Main Menu	Roadside Assistance Agent Assistance Service Link Quick Tips Main Menu

- Press the **Navigation** button for navigation-related services.
- Press the **SOS** button for SOS Emergency Assistance.
- Refer to your Blue Link User's Manual for detailed information on system operation.
- For immediate assistance with subscription services, please call 1-855-2BLUELINK (1-855-225-8354).

### Remote Door Unlock/Lock

#### Blue Link Mobile App



You can download the Blue Link mobile app to your compatible smart phone from the following sites:

- iPhone® — Apple® App Store
- Android® — Google Play
- BlackBerry® — BlackBerry® App World

With this feature, you can lock or unlock your vehicle doors from virtually anywhere by using the Blue Link mobile phone app, by dialing the toll-free number, or by using the Blue Link owner's website.

- To use this feature, you must have a Blue Link Personal Identification Number (PIN). To create or change your PIN, log on to [www.MyHyundai.com](http://www.MyHyundai.com).

#### To Activate Remote Door Unlock/Lock

- By Blue Link Mobile App: Select DOOR UNLOCK or DOOR LOCK, as desired.
  - Enter your Blue Link PIN.
  - The command to lock or unlock your doors will be sent to your vehicle.
- By phone: Dial toll-free 1-855-2-BLUELINK (1-855-225-8354).
- By web site: Log on to [www.MyHyundai.com](http://www.MyHyundai.com), select Blue Link.
  - Select Remote Services, then Remote Door Unlock/Lock.
  - Input your Blue Link PIN. (If you need time to get to your vehicle, specify a time delay before your vehicle will be unlocked.)

## STANDARD RADIO [Type A]

### Audio mode

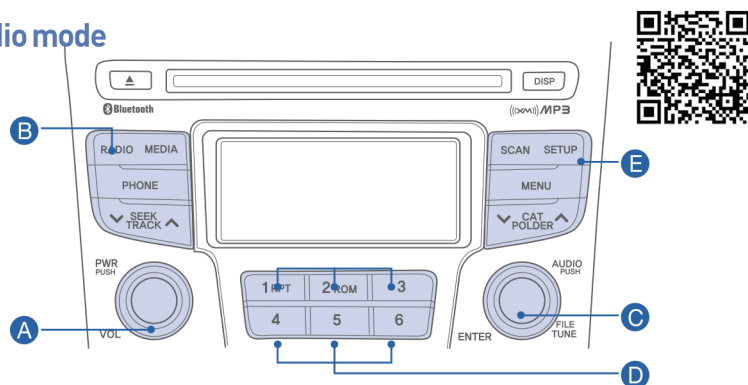

Press POWER button **A** to turn radio on.

#### • TUNING / LISTENING TO CHANNELS

1. Press RADIO button **B** to select FM/AM/XM.
2. Rotate TUNE knob **C** to desired channel.

#### NOTE

A clear view of the southern sky is recommended to ensure XM® radio reception.

#### • SETTING PRESET MEMORY BUTTONS (FM/AM/XM®)

Press and hold any preset button (1-6) **D** until audible beep is heard to store current channel.

#### • ADJUSTING THE SOUND CONTROL

1. Press the SETUP button **E**.
2. Select “Sound” by turning and pressing the TUNE knob **C**.
3. Select “Bass,” “Middle,” “Treble,” “Fader,” or “Balance” by turning and pressing the TUNE knob **C**.
4. Adjust the sound by turning and pressing the TUNE knob **C**.

Please refer to your Owner's Manual for more detailed information on how to use your audio system.  
Complimentary XM® subscription ends three months following the vehicle date of sale.  
Please contact XM® Radio at 1-800-XM-RADIO (1-800-967-2346) to renew your XM® subscription.

## STANDARD RADIO [Type B]

### Audio mode

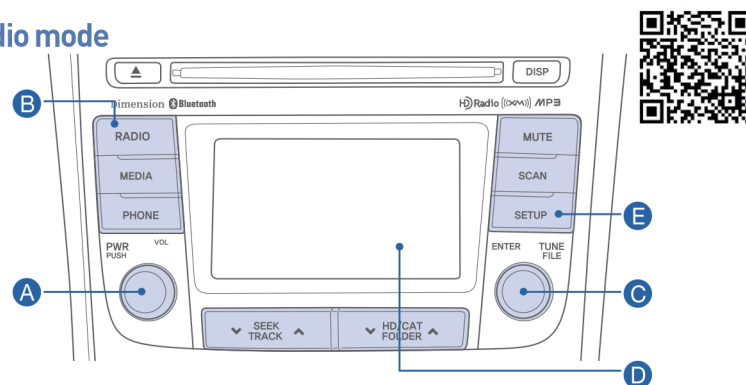

Press POWER button **A** to turn radio on.

#### • TUNING / LISTENING TO CHANNELS

1. Press RADIO button **B** to select FM/AM/XM.
2. Rotate TUNE knob **C** to desired channel.

#### NOTE

A clear view of the southern sky is recommended to ensure XM® radio reception.

#### • SETTING PRESET MEMORY BUTTONS (FM/AM/XM®)

Press and hold any preset button **D** on screen.

#### • ADJUSTING THE SOUND CONTROL

1. Press the SETUP button **E**.
2. Press the “Sound” button on the screen.
3. Press “Sound Setting” button on the screen.

Please refer to your Owner's Manual for more detailed information on how to use your audio system.  
Complimentary XM® subscription ends three months following the vehicle date of sale.  
Please contact XM® Radio at 1-800-XM-RADIO (1-800-967-2346) to renew your XM® subscription.





## MULTIMEDIA

### NAVIGATION

#### Audio mode

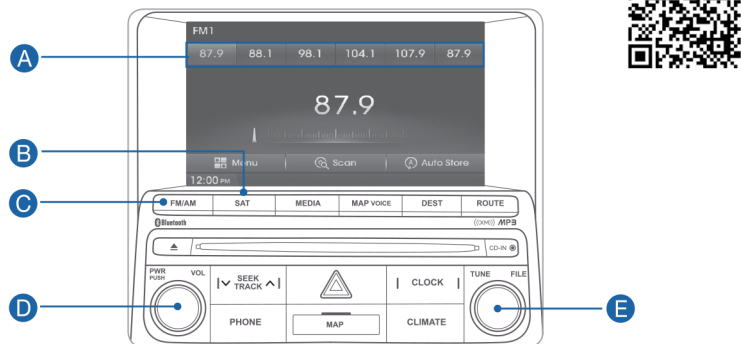

Press **POWER** button **D** to turn radio on.

#### • TUNING/LISTENING TO CHANNELS

1. Press FM/AM **C** or SAT **B**.
2. Rotate TUNE knob **E** to desired channel.

#### NOTE

A clear view of the southern sky is recommended to ensure XM<sup>®</sup> radio reception.

#### • SETTING PRESET MEMORY BUTTONS (FM/AM/XM<sup>®</sup>)

Press and hold any preset button (1-6) **A** until audible beep is heard to store current channel.

#### • ADJUSTING THE SOUND CONTROL

1. Press Sound **E** to enter SETUP menu.
2. Touch on-screen arrows to adjust desired setting.

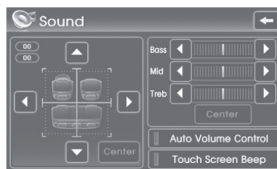

### Blue Link Telematics System

Your audio display will change during Blue Link system use. Please refer to the Blue Link User's Manual for detailed information on system use.



#### Map position

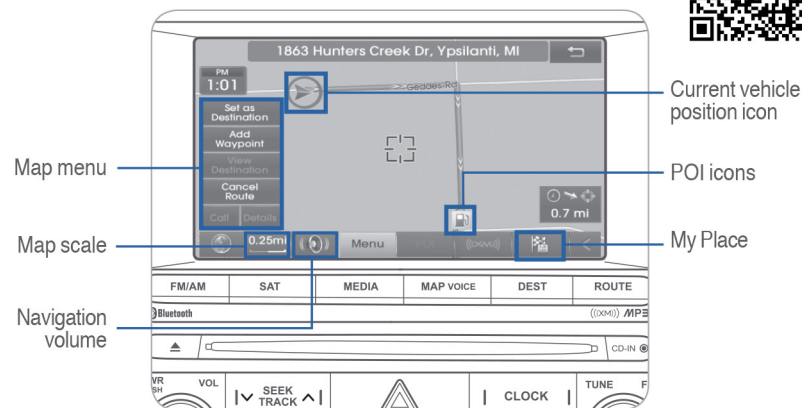

### Destination menu

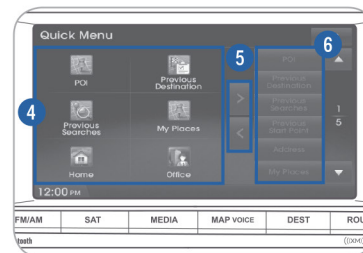
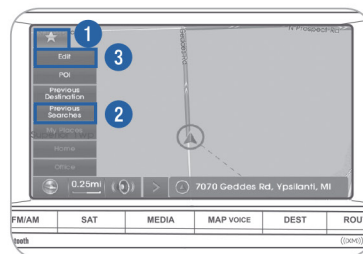

### Quick Menu

Press the **★** button on the left side of the map screen to display the Quick Menu.

1. Quick Menu **★** – Display/hide Quick Menus
2. Quick Menu Bar – Menus added to the Quick Menu (possible to set up to 6 menus)
3. Edit - Add/Delete Quick Menus
4. Current Quick Menus – Shows list of current Quick Menus
5. Add/Remove – Add or remove Quick Menus
6. Quick Menu Categories – List of categories that can be added to Quick Menus



## MULTIMEDIA

### AUX, USB AND iPod® PORT

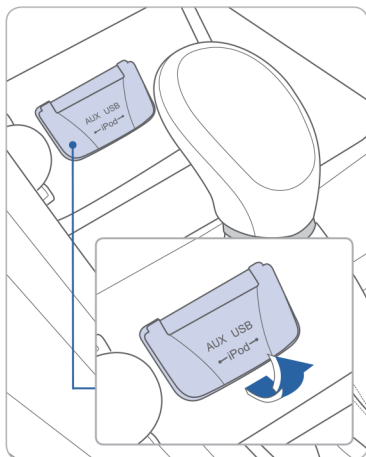

Use the jack to connect an external audio device and listen to it through the audio system speakers in your vehicle.

#### NOTE

To operate your iPod® through the vehicle's audio system, a Hyundai adapter cable is required. This cable can only be purchased at your local Hyundai dealer.

iPod® is a trademark of Apple Inc.

### CLOCK ADJUSTMENT

#### With Standard Radio

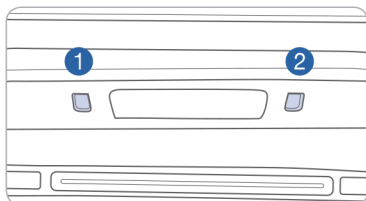

#### Hour

Press the ① button to adjust the Hour.

#### Minute

Press the ② button to adjust the Minute.

#### With Navigation Radio

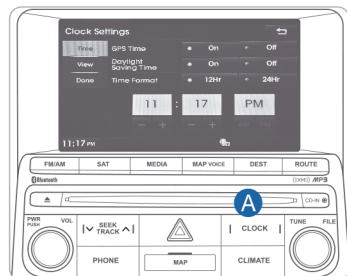

1. Press and hold button A.
2. Touch the up or down arrows to set the clock.
3. Touch "Done" when finished.



## FEATURES AND CONTROLS

### AUTOMATIC TRANSMISSION

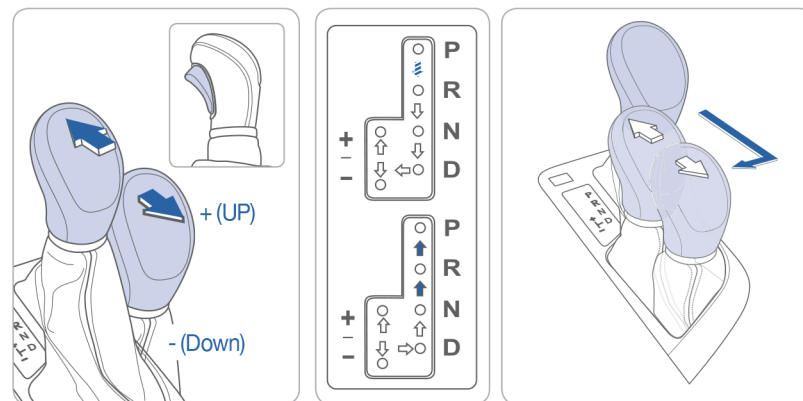

(➡) : Shift with the brake pedal and lock release button.

(⇔) : Shifts freely.

#### Sport mode

Move the shift lever from D to the left gate to select. Move the shift lever forward (+) to upshift or rearward (-) to downshift.

### PADDLE SHIFTER

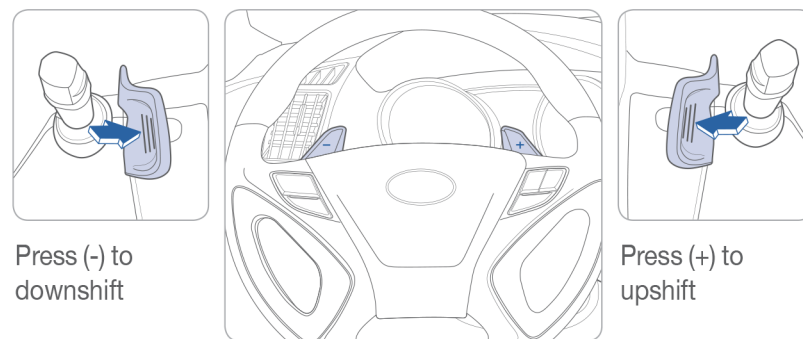

Press (-) to downshift

Press (+) to upshift

Pull the [+] or [-] paddle shifter once to shift up or down one gear.

## TIRE PRESSURE MONITORING SYSTEM (TPMS)

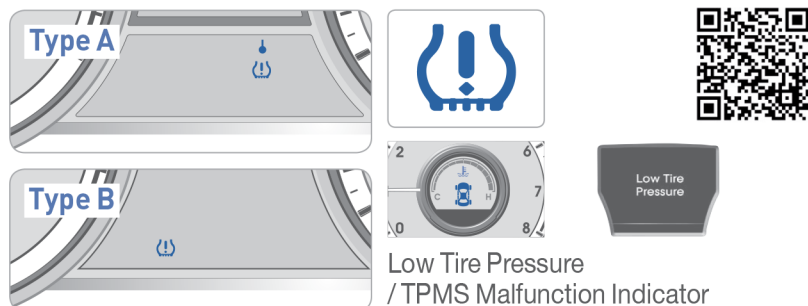

### LOW TIRE PRESSURE INDICATOR

Illuminates if one or more of your tires is significantly under-inflated.

### TPMS MALFUNCTION INDICATOR

Blinks for approximately one minute then remains illuminated if there is a malfunction with the TPMS system. Have the system checked by an authorized Hyundai dealer.

### LOW TIRE PRESSURE POSITION

Indicates which tire is significantly under-inflated by illuminating the corresponding position.

### NOTE

When the low tire pressure indicator is illuminated, inflate tire to proper tire pressure as soon as possible. Tire pressure may vary in colder temperatures, causing the low tire pressure indicator to illuminate.

### REFERENCE

16" & 17" wheels – 34 psi

18" wheels – 35 psi

## ELECTRONIC STABILITY CONTROL (ESC)

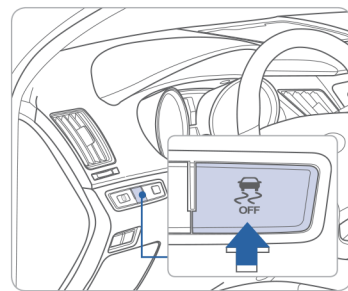

The ESC system is an electronic system designed to help the driver maintain vehicle control under adverse conditions.

- To turn the ESC off, press the ESC OFF button.
- To turn ESC on, Press it again.
- System defaults to ON position at start.

## ACTIVE ECO SYSTEM

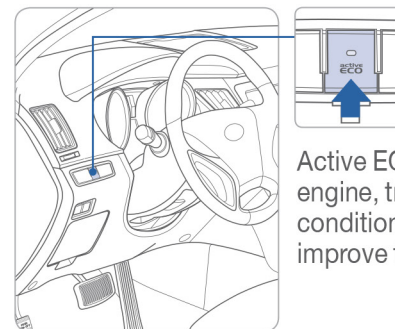

Active ECO system modifies the engine, transmission, and air conditioning operation for improve fuel economy.

### Tips to Improve Fuel Economy

- Accelerate at a moderate rate
- Avoid unnecessary braking
- Drive between 55-65 mph on the freeway
- Keep tires inflated at pressures on placard

## REARVIEW CAMERA

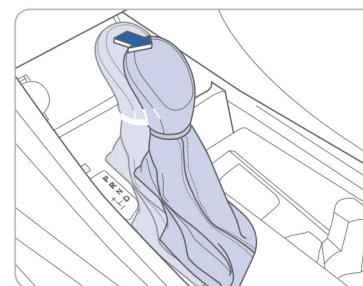

The rearview camera will activate when the ignition switch is ON and the shift lever is in the R (Reverse) position.

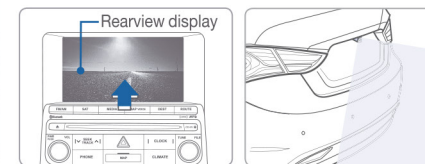

## BLIND SPOT DETECTION SYSTEM (BSD) [if equipped]

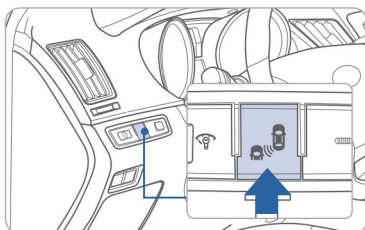

The BSD system sensor senses the rear side territory of the vehicle and provides information to the driver. Press the BSD switch. If vehicle speed exceeds 18.6 mph the system will activate. Press the switch again to deactivate the system.



**1** Blind spot detection (BSD)  
Warning range is dependent on your vehicle speed. However, if your vehicle speed is about 18.6 mph than other vehicle, the warning is not operated.

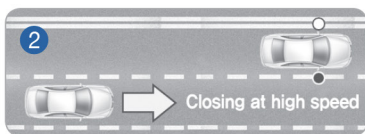

**2** Lane change assist (LCA)  
When the vehicle is approaching to your vehicle at high speed, the warning is operated.

## SEAT WARMER/COOLER

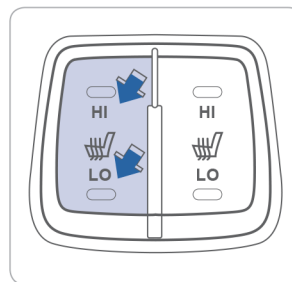

### TYPE A

Seat Warmer

Top – High  
Bottom – Low

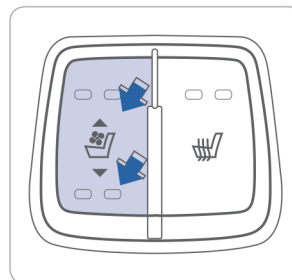

### TYPE B

Seat Warmer and Cooler (Driver seat only)

Top – Heat (red)  
Bottom – Cool (blue)

## Key Websites

Hyundai website - [www.hyundai.com](http://www.hyundai.com)

Hyundai owner website - [www.myhyundai.com](http://www.myhyundai.com)

Bluetooth phone compatibility - [www.hyundaiusa.com/bluetooth](http://www.hyundaiusa.com/bluetooth)

Blue Link - [www.hyundaiusa.com/technology/bluelink](http://www.hyundaiusa.com/technology/bluelink)



## SONATA CUSTOMER DELIVERY CHECK LIST

HYUNDAI OWNER	DEALERSHIP NAME
SALES CONSULTANT	DATE
VIN	PREVIOUS VEHICLE

### BEFORE DELIVERY

- ☐ CONFIRM "GOOD BATTERY" USING GR8 AND STAPLE TEST TICKET HERE
- ☐ SET TIRE PRESSURE TO PLACARD LF \_\_\_\_ RF \_\_\_\_ RR \_\_\_\_ LR \_\_\_\_
- ☐ VERIFY VEHICLE IS CLEAN, IN GOOD CONDITION, FREE OF CHIPS AND SCRATCHES - CLEAN WINDSHIELD AND BACK WINDOW
- ☐ ENSURE FLOORMATS ARE SNAPPED INTO PLACE

## WALK THE CUSTOMER THROUGH EACH OF THE FOLLOWING KEY DELIVERY FEATURES

- ☐ DEMONSTRATE DEFROST – pages 16 and 18
  - ① Select front windshield defroster
  - ② Set to warmest temperature setting.
  - ③ Set to highest fan speed.
- ☐ BLUETOOTH – pages 22 – 25
  - Show phone compatibility website: [www.hyundaiusa.com/bluetooth](http://www.hyundaiusa.com/bluetooth)
  - Make a test call using Bluetooth with the customer's phone
  - Demonstrate Voice Recognition (VR)
- ☐ BLUE LINK – pages 26 – 27
  - Show website: [www.hyundaiusa.com/technology/bluelink](http://www.hyundaiusa.com/technology/bluelink)
  - Demonstrate Point of Interest (POI) search and download
  - Ensure customer understands subscription process
- ☐ TIRE PRESSURE MONITORING SYSTEM (TPMS) – page 34
  - Explain TPMS function to customer
  - When illuminated, one or more tires are under-inflated.
  - Blinks for approximately one minute then remains illuminated when there is a malfunction with the TPMS
- ☐ VEHICLE SETTINGS – pages 28 – 29 and 30 – 31
  - Demonstrate vehicle settings in instrument cluster
  - Demonstrate navigation use, enter dealer address
  - Show radio presets
- ☐ CLOCK – pages 32
  - Demonstrate how to set clock (including daylight savings setting for Navigation equipped vehicles)



Sales Consultant	Date	Sales Manager	Date
Customer	Date		
Email			